

# HS 80 - 150000/0.5

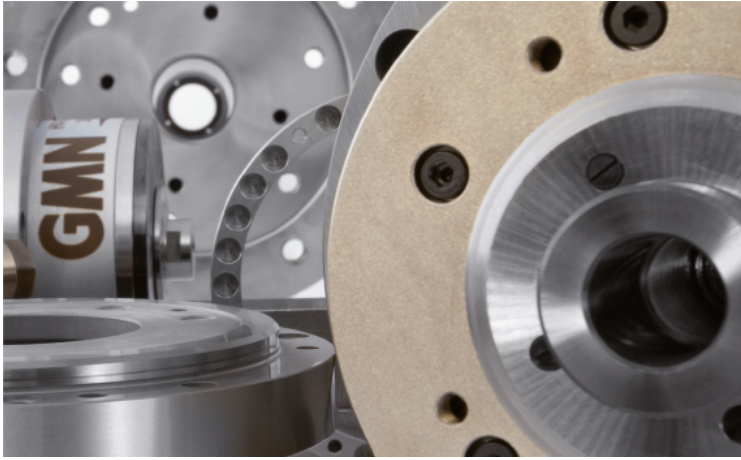

## Technical data

∅ Spindle housing	A	[mm]
Speed max.	$n_{max}$	[min <sup>-1</sup> ]
Bearing; front	$W_1$	[mm]
<b>Tool interface</b>		
∅ Flat layout	W	[mm]
<b>Static rigidity</b>		
axial	$C_{ax}$	[N/μm]
radial	$C_{rad}$	[N/μm]
<b>Motor realization</b>		
Frequency max.	$f_{max}$	[Hz]
Converter voltage <sup>1)</sup>		[V]
Power	$P_{S1}$	[kW]
Torque	$M_{S1}$	[Nm]
... at speed	$n$	[min <sup>-1</sup> ]
Current	$I_{S1}$	[A]
Power	$P_{S6-60\%}$	[kW]
Torque	$M_{S6-60\%}$	[Nm]
... at speed	$n$	[min <sup>-1</sup> ]
Current	$I_{S6-60\%}$	[A]

## HS 80 - 150000/0.5

80		
150000		
8		
D 04/08		
8		
9		
15		
200 V	-	-
2500		
200	-	-
0,45		
0,0286		
150000		
2,3	-	-
0,5		
0,0318		
150000		
2,5	-	-

## TECHNICAL DATA

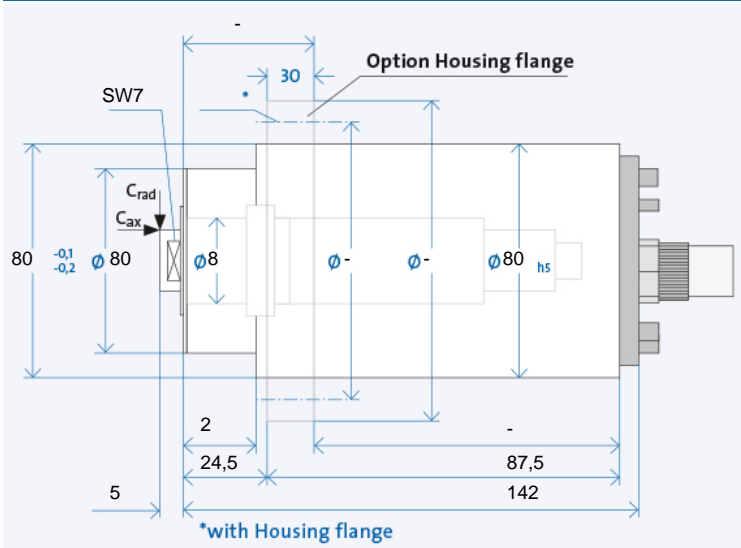

## Electrical connection

Plug type	GA	-	-
Straight plug connection	+	-	-
Coil plug connector	x	-	-
Fixed cable XXm	o	-	-

## Coolant feed through the shaft

Low pressure (du)	-
High-pressure (dh)	-

## Sensors

Rotary encoder	-
Speed sensor	-

## Housing

Cylindrical housing	+
Cylindrical housing with flange	x
Block housing	x
Air-tight seal	x

<sup>1)</sup> Minimum required starting voltage for the frequency converter.

- + Standard
- o Optional
- x Upon request

## Ordering information:

HS 80 - 150000/0.5  
 R is for clockwise, L for counter-clockwise  
 + Desired options

GA	-	-
+	-	-
x	-	-
o	-	-
<b>Coolant feed through the shaft</b>		
Low pressure (du)	-	-
High-pressure (dh)	-	-
<b>Sensors</b>		
Rotary encoder	-	-
Speed sensor	-	-
<b>Housing</b>		
Cylindrical housing	+	-
Cylindrical housing with flange	x	-
Block housing	x	-
Air-tight seal	x	-

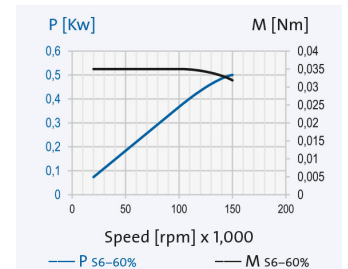

## FIT HOLES WITH FLAT LAYOUT

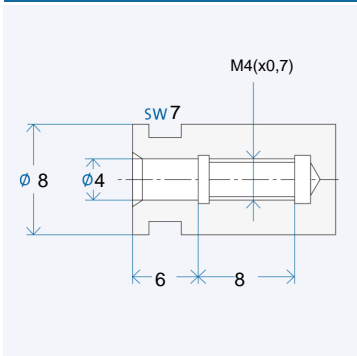

## ANGLED PLUG OPTION

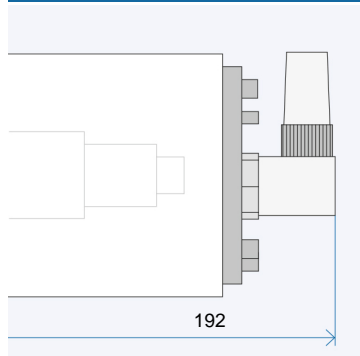

The data currently provided on the internet apply. Further and detailed information is provided in the GMN 2508 catalogue.

# HS 80 - 150000/0.5



## Lubrication system

The electronically controlled PRELUB lubrication unit is optimally adapted to the oil-air lubricated GMN spindles and guarantees a long service life.



## Cooling system

GMN cooling units ensure precisely adjustable temperature and quantity delivery of the coolant and achieve consistently low operating temperatures.



## Cable and plug

Ready-made cables with B048, B049, GA, MAC, D500 and STK plugs are available on request. For the spindle/converter connection, GMN supplies UL/CSA approved electrical cables suitable for use in drag chains.