

# Spindle ball bearings (HY)\* S 61907 E

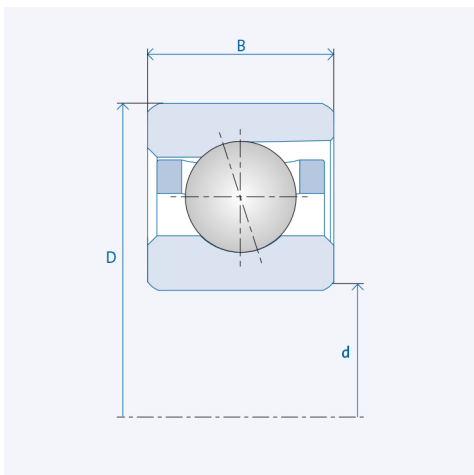

## Precision class P4 / ABEC7

### Components

Bearing designation:	(HY)* S 61907 E
Bearing design:	S
Series / size:	61907
Ball material:	Steel 100Cr6
Ball material HY :	Ceramic Si3N4
Cage:	TA (TXM available upon request)
Precision:	P4 (HG, UP, P2 upon request)
Main dimensions [d x D x B]:	35 x 55 x 10 mm

### Technical data (Standard bearings)

Static load capacity $C_0$ :	8200
Dynamic load capacity C:	10300
Speed limit $n_{Fett}$ :	24000
Speed limit $n_{Oj}$ :	32000

### Technical data (Hybrid bearings)\*

Static load capacity $C_{0HY}$ :	5750
Dynamic load capacity $C_{HY}$ :	10300
Speed limit $n_{Fett}$ :	30000
Speed limit $n_{Oj}$ :	40000

### Pre-tension

Light (L):	90 N
Axial rigidity ( $C_{ax}$ ):	91 N/ $\mu$ m
Medium (M):	260 N
Axial rigidity ( $C_{ax}$ ):	135 N/ $\mu$ m
Heavy (S):	520 N
Axial rigidity ( $C_{ax}$ ):	177 N/ $\mu$ m
Spring preload (Ff):	375 N

The given speed limits apply to individual bearings with spring preload. Correction factors must be considered for all properties which deviate from this.

\* All ball bearings are also available as hybrid ball bearings (HY).