

Labyrinth plastic seal Type S



S 85 X 120 X 15

Item number 301678

Technical data

Material:	High-quality polyoxymethylene (POM)
Inner diameter ID:	85 mm
Outer diameter OD:	120 mm
Installed width W:	15 mm
Sealing gap:	Conical
Axial play S_{ax}^* :	0.8 mm
Gap diameter e_1 :	96 mm
Gap diameter e_2 :	112 mm
Speed limit:	10800 rpm
Weight:	0.099 kg
Operating temperature t:	-40° - 60°C

*Entire movability from one end position to the other

Installation

"l" Length (chamfering of shaft and housing) depending on the width W: $l = 0,1 \times W$

Component tolerances

Surrounding structure (mating parts)

Housing: H7 / Shaft: h7

Surface quality: $Rz \leq 16 \mu\text{m}$; $Ra \leq 3,2 \mu\text{m}$

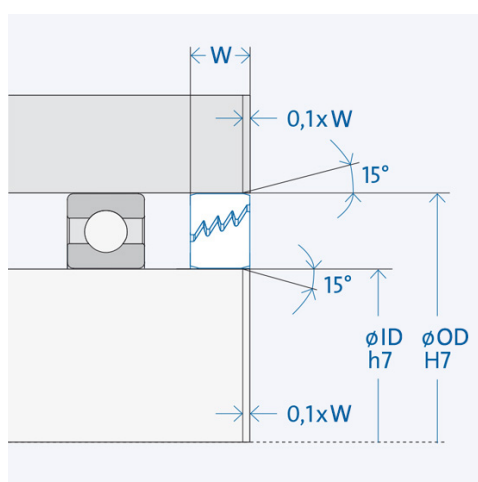
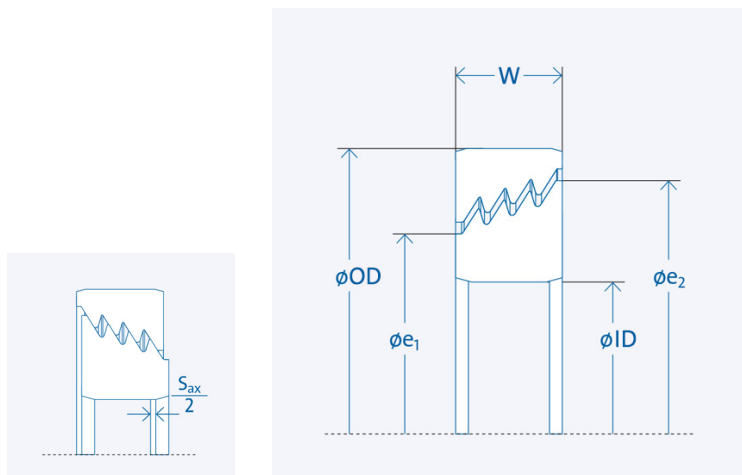

The larger gap diameter e_2 must always face the impact.