

Labyrinth seal for spindle bearings

Type CF...S10



CF 6019 S10

Item number 307141

Technical data

Material:	Steel
Hardness:	≥ 45 HRC
Plane-parallelism:	≤ 5 μm
Inner diameter ID:	95 mm
Outer diameter OD:	145 mm
Installed width W:	6 mm
Sealing gap:	Axial/radial
Axial play S_{ax}^* :	1 mm
Radial play S_{rad}^* :	0.5 mm
Gap diameter e_1 :	112 mm
Gap diameter e_2 :	122 mm
Speed limit ^{**} :	unlimited
Weight:	0.447 kg
Operating temperature t:	-40° - 170°C

*Entire movability from one end position to the other
^{**}CF...S10 designs have no axial movement in the press compound between the spindle bearing and the shaft nut, and allow unlimited speed in this arrangement.

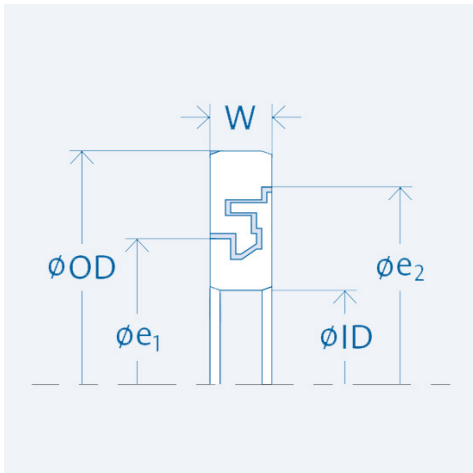

Installation

The seal is designed to be assembled directly in contact to the spindle bearing. Inner and outer ring must be secured axially. The spindle bearing could be preloaded directly through the seal.

Component tolerances

Width W = 6 mm (0/ -20 μm)

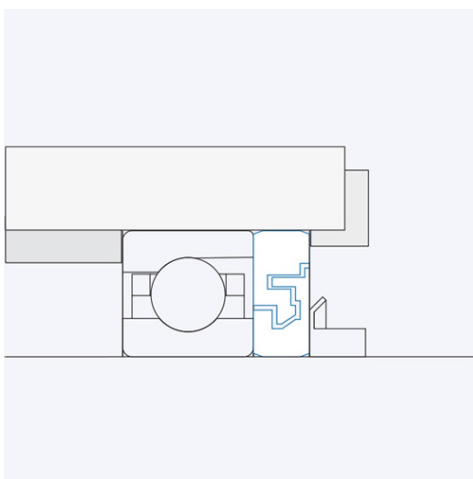

The larger gap diameter e_2 must always face the impact.

bore inner ring d [mm]				
above	18	30	50	80
to	30	50	80	120
max. tolerance [μm]	10	12	14	16
min. tolerance [μm]	0	0	0	0
outer diameter outer ring D [mm]				
above	30	50	80	120
to	50	80	120	150
max. tolerance [μm]	0	0	0	0
min. tolerance [μm]	-12	-14	-16	-18